

LONG SECTION 4

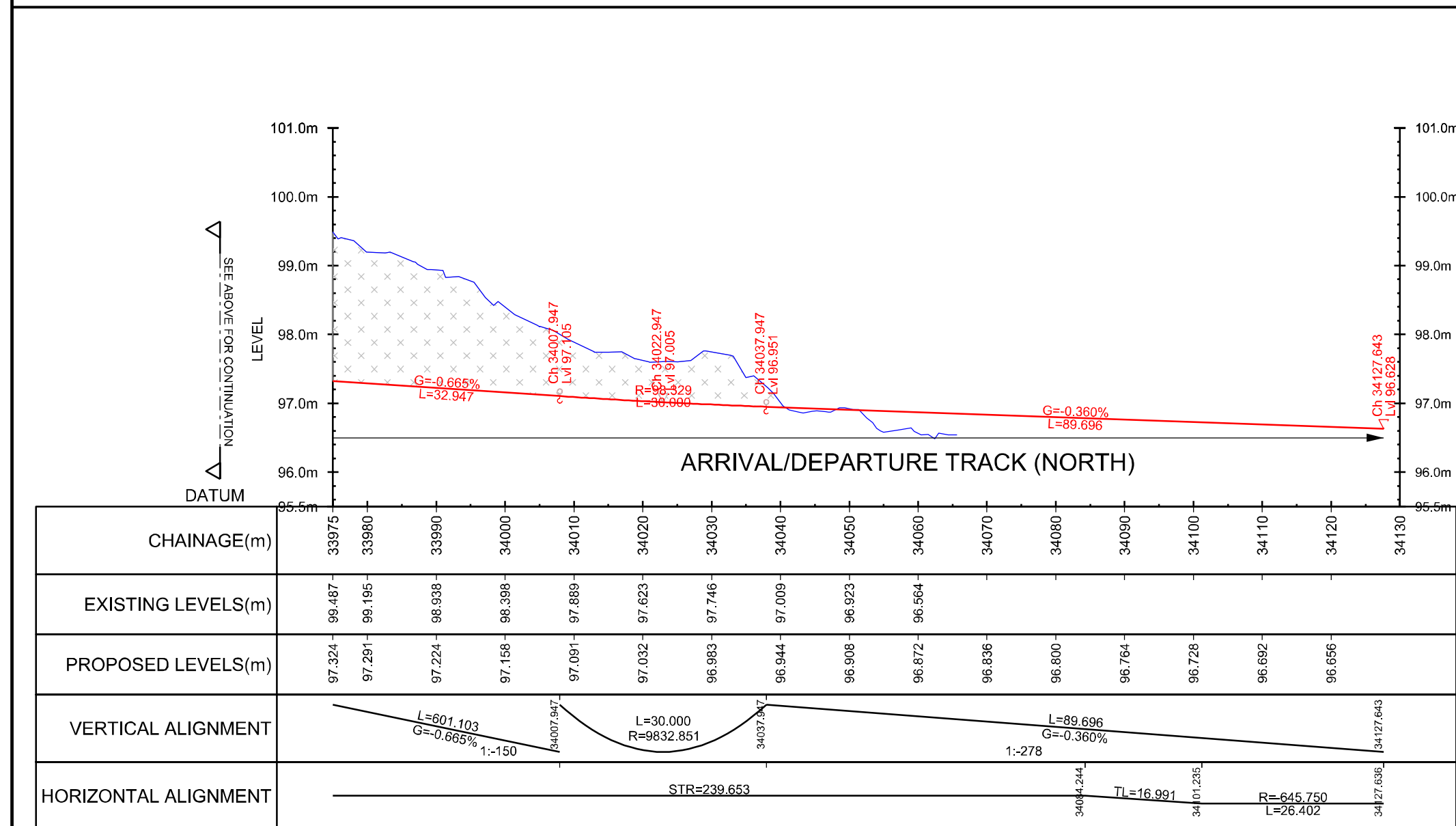

LONG SECTION 5

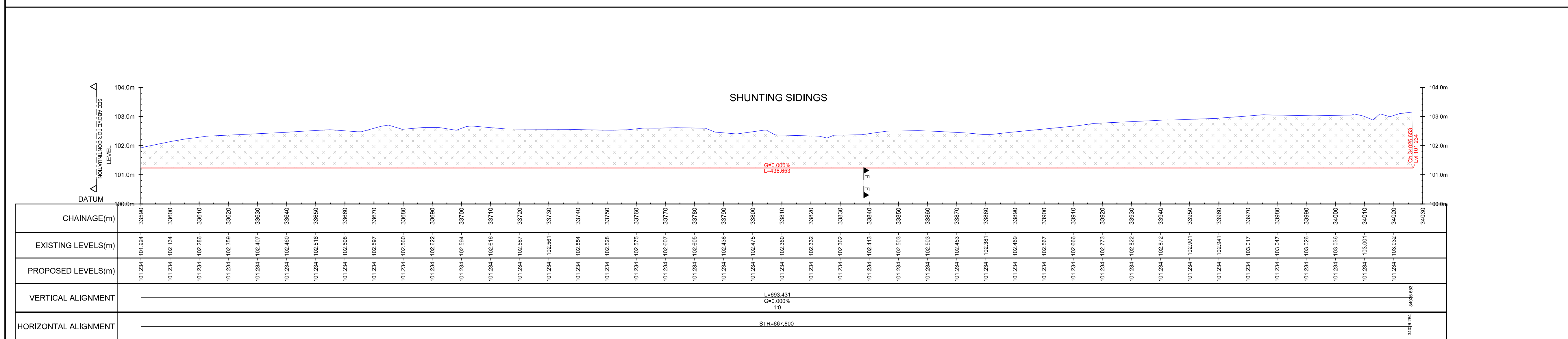

LONG SECTION 6

- Legend/Notes
- This drawing is to be read in conjunction with all other relevant drawings and specifications. See Document 2.14 for Railway General Arrangement. See Documents 2.16A to C for Railway Cross Sections.
  - This drawing is based on the Ordnance Survey Data issued by Chetwoods licence no. 100031961 and verified with 1m ea LIDAR height data licence no. 70920949. All design information is subject to confirmation by rail corridor topographic survey.
  - Site datum (design datum) chainage of 32055m is set at point of switch of proposed connection turnout on Down Penkridge main line at approximately 19m 150yds and increasing with the track mileage.
  - Long section taken along Arrival/Departure (south) - Siding 4 - Arrival/Departure (north). Proposed track works and specific alignments are subject to detailed design.

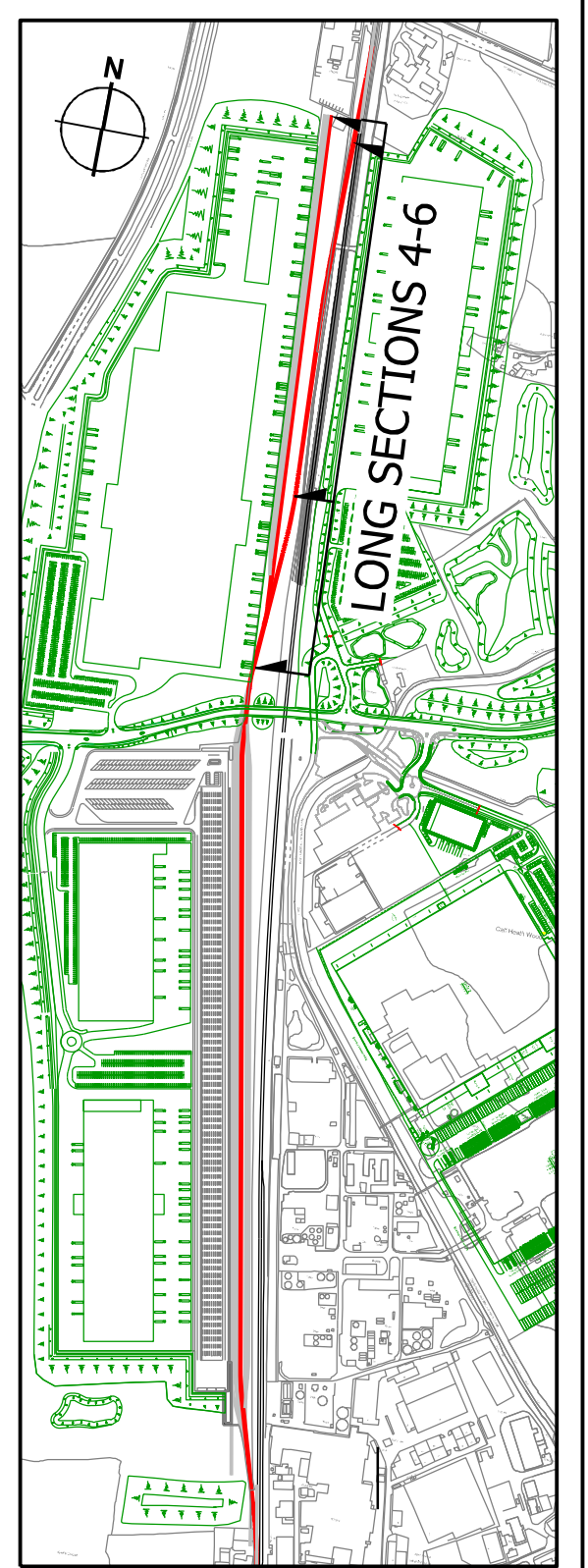

REVISED TO REFLECT E33 SUBMISSION  
 FOR E33 SUBMISSION  
 NOV 2017



Project  
 The West Midlands Rail Freight Interchange Order 2020

Drawing Status  
 SUBMISSION

Drawing Title  
 RAIL ALIGNMENT  
 LONG SECTIONS - SHEET 2

Regulation  
 5 (2) (o)

Document  
 2.16E

Drawn AT Date MAR 2018 Scale 1:750 (A1) Reviewed MT

Drawing No. TRS-DRG-FA-001008 Rev. 02